



Portable solar system

1、 Product features

2000W-6000W (Lithium battery)

Product Features

- Excellent performance because of double CPU intelligent control technology;
- A wide range of applicable loads because of pure sine wave AC output
- The mains supply mode/energy-saving mode/battery mode can be set for flexible
- Convenient and practical 5VDC-USB output port and 12VDC output port;
- Digital LCD and LEDs for visualization of operation status of the equipment
- Overcharge protection and over discharge protection for a longer battery life;;
- Safe and reliable with intelligent exhaust fan control
- Overall automatic protection and alarms including AC output overload protection. short circuit protection. etc.

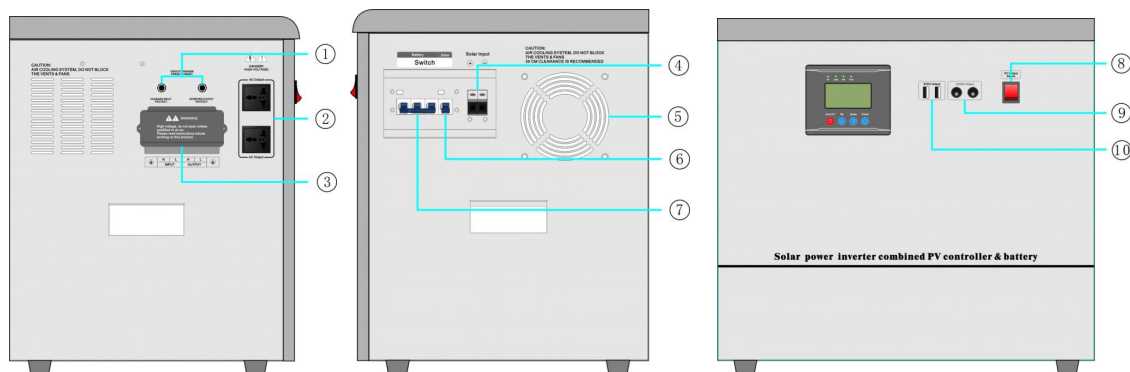

Guide

- ①-- AC input/output fuse holder
- ②-- AC Output
- ③-- AC input/output terminal
- ④-- Solar input port
- ⑤-- Fan
- ⑥--Solar input breaker
- ⑦-- Battery input breaker
- ⑧-- 5VDC-USB、12VDCoutput ON/OFF switch
- ⑨-- 12VDC Output: 12VDC-USB output terminal
- ⑩-- 5VDC Output: 5VDCoutput terminal

System configuration

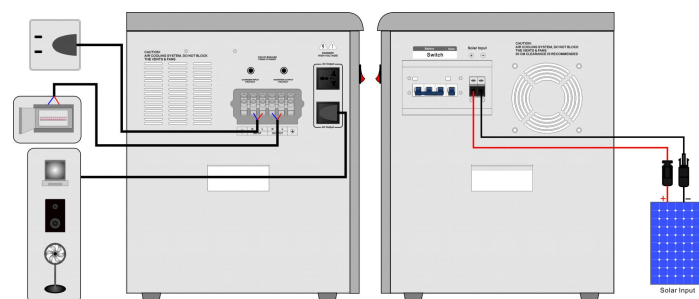

TECHNICAL DATA

Model		2000W	3000W	4000W/5000W/6000W	
Battery rated voltage (vdc)		25.6/51.2	25.6/51.2	51.2	
Inverter	Rated power (w)	2000	3000	4000	5000
	Input voltage range (vac)	85-138VAC/140-275VAC			
	Input frequency (Hz)	45-65			
	Output voltage (vac)	110/220			
	Output frequency (Hz)	50/60			
	Output wave	Pure Sine Wave			
	Specification of built-in Lifepo4 Battery	100AH/161AH/200AH			
MPPT Solar input	MPPT Voltage Range	30V~150VDC		60V~150VDC	
	PV Power	1600W(25.6V)		3200W(51.2V)	
	Rated charge current	60A(Max)			60A (Max)
	MPPT efficiency	≥97%			
	Floating charge voltage	/	/	/	/
DC output	Voltage for high voltage protection	34 VDC	34 VDC	58 VDC	66/60 VDC
	High voltage recovery voltage	31 VDC	31 VDC	52 VDC	60/56VDC
	Low voltage recovery voltage	25 VDC	26 VDC	44 VDC	51/48 VDC
	Low voltage protection voltage	22 VDC	22 VDC	36 VDC	45/43VDC
	5VDC USB output	2Units/MAX 2A			
	12VDC output ports	2Units/MAX 2A			
Heat dissipation/Cooling		Temperature control by intelligent exhaust fan			
Operating ambient temperature		-20 - +50℃			
Storage ambient temperature		-25 - +55℃			
Operating/Storage ambient		0-90% No condensation			
External size: W*D*H (mm)		620*420*580			
Package size: W*D*H (mm)		720*520*760			